

How to Access MyLOFT:

The new remote access tool for accessing the e-resources

MyLOFT - My Library On Fingertips

Experience the intelligence of discovering, accessing, saving & sharing e-content



MyLOFT Remote Access can be accessed in two ways: 1. Mobile and 2. Web Browser.

1. Mobile:

- ✓ Search for the MyLoft app in Google Play (for Android 5 and above) or Apple App Store (for iOS 11 and above)
- ✓ Click on 'install' option
- ✓ Click 'Open' once installed

2. Web:

- ✓ Visit <https://app.myloft.xyz/> on your web browser
- ✓ To access the institute subscribed e-resources from remote locations and save articles in MyLOFT WebApp,
- ✓ Download browser Extension for Google Chrome or Microsoft Edge

Prepared by.

Dr. K. S. Ali

Dy. Librarian & Assistant Professor

Central Library

Yenepoya (Deemed to be University)

E-Mail – aliks@yenepoya.edu.in,

Extn. no. 5085, Ph. No. 09686618671

Verified by:

Dr. Mamatha P.K

Chief Librarian & Assistant Professor

Central Library

Yenepoya (Deemed to be University)

E-mail: library@yenepoya.edu.in

Extn. no.2067 Phone no. +91-9845783853

2021-22

Step – 2

1. Request for Login Credentials, send email to:- e-resources@yenepoya.du.in
2. And also fill the online form: <https://tinyurl.com/yenmyloft>
3. Once User ID Will created by MyLOFT@Yenepoya Admin. than User’s will receive the password generate e-mail from MyLOFT
4. User’s need to create new password as instructed by MyLOFT

A) How to register on MyLOFT?

(Institute affiliated email ID and Password)

01. To get started, please contact **your library** and request for your MyLOFT account.
02. Once the library creates your account, a welcome mail reaches your **institute affiliated email id** with a **“Set Password”** option.(if not found, check Promotions or Spam folder).
03. Click on the **“Set Password”** button to open the app and **create a strong password** for your MyLOFT account. If the app is not installed, the password creation page will open in the browser window.
04. Once the password is set, the option to **“Sign In”** appears.

The image shows a sequence of three screenshots illustrating the registration process:

- 01:** A library building icon with a "LIBRARY" sign.
- 02:** An email notification from MyLOFT. The text says: "Dear [User Name], We are glad to inform you that [your institute]E-Library has introduced MyLOFT for all your e-Content needs. Now you can access, save and organize e-content subscribed by [your institute] using MyLOFT App." A "SET PASSWORD" button is highlighted with a red box and a red arrow labeled "02".
- 03:** A "Create your password" form. The text says: "Now set your password and log in to MyLOFT". The form includes a list of password requirements:
 - Must be at least 8 characters!
 - Must contain at least 1 number!
 - Must contain at least 1 Letter in Capital Case!
 - Must contain at least 1 Letter in Small Case!
 - Must contain at least 1 Special Character!
 Below the requirements are two input fields: "Password *" and "Confirm password *". A "Continue" button is at the bottom right. A red arrow labeled "03" points to the requirements list.

Yenepoya Online Form for MyLOFT User ID Credentials

gUYZjW0vtqayOthzHLeRzShOiu44Ng23kCqR0qLGjIQQ/viewform?vc=0&c=0&w=1&

Remote Access (MyLOFT) Application Form

For Access the MyLOFT account you will receive the notification email with link to create the password for Log-In to the MyLOFT - <https://app.myloft.xyz/>

Any Technical Issues, kindly contact - Dr. K. S. Ali, Dy. Librarian & Assistant Professor, Central Library, e-resources@yenepoya.edu.in, Ext. No. 5085/5115, phone no. 09686618671

e-resources@yenepoya.edu.in (not shared)

* Required

Campus /Employee ID *

Your answer

Full Name *

Your answer

Email ID *

Your answer

Step – 2

1. Open <https://app.myloft.xyz/>
2. Add Institutional name as “Yenepoya University, Mangalore”
3. Add Login ID (your email ID) & password created by you and Sign In
4. Download browser Extension for Google Chrome or Microsoft Edge

B) How to sign in? For Desktop

(Institute affiliated email ID and Password)

01. Open MyLOFT WebApp in **Google Chrome** or **Microsoft Edge** using URL: <https://app.myloft.xyz/>.



02. Select your institute from the list.

03. **Enter your email id** provided to the library during **Step A.1** and the **password** which you created in **A.3**.

B) How to sign in? For Desktop

(Institute affiliated email ID and Password)

04. A warning message will appear on the below header area of the Webapp and will prompt you to **install MyLOFT Browser Extension**.

05. Click on **“Add Extension”** and proceed to Install in individual browser stores (**Chrome WebStore/ Microsoft Edge Add-ons**).

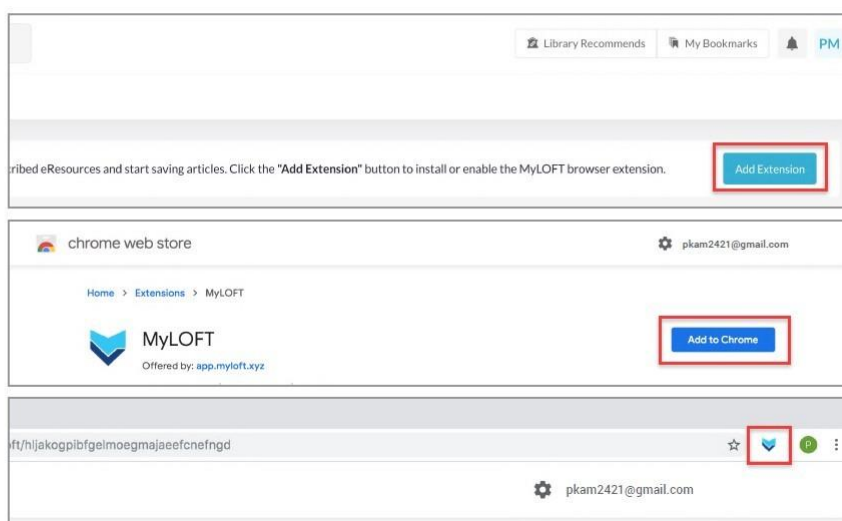

Step- 3

B) How to sign in? For Mobile

(Institute affiliated email ID and Password)

01. Open the MyLOFT app on your mobile.
02. **Select your institute** from the list.
03. **Enter your email id** provided to the library during **Step A.1** and the **password** which you created in **A.3**.

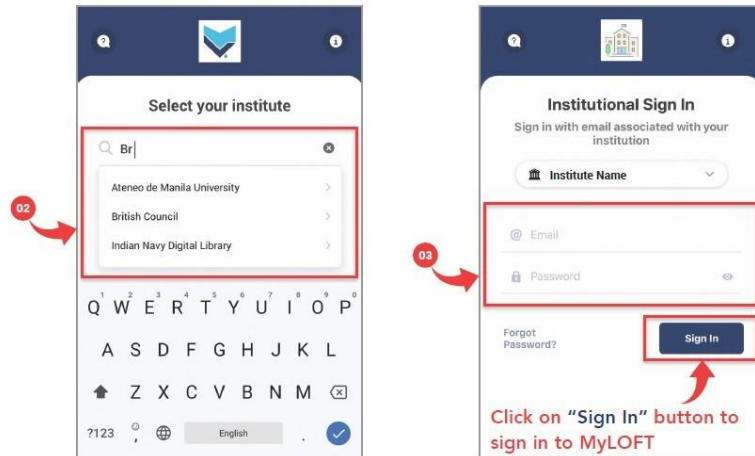

Yenepoya - MyLOFT Page

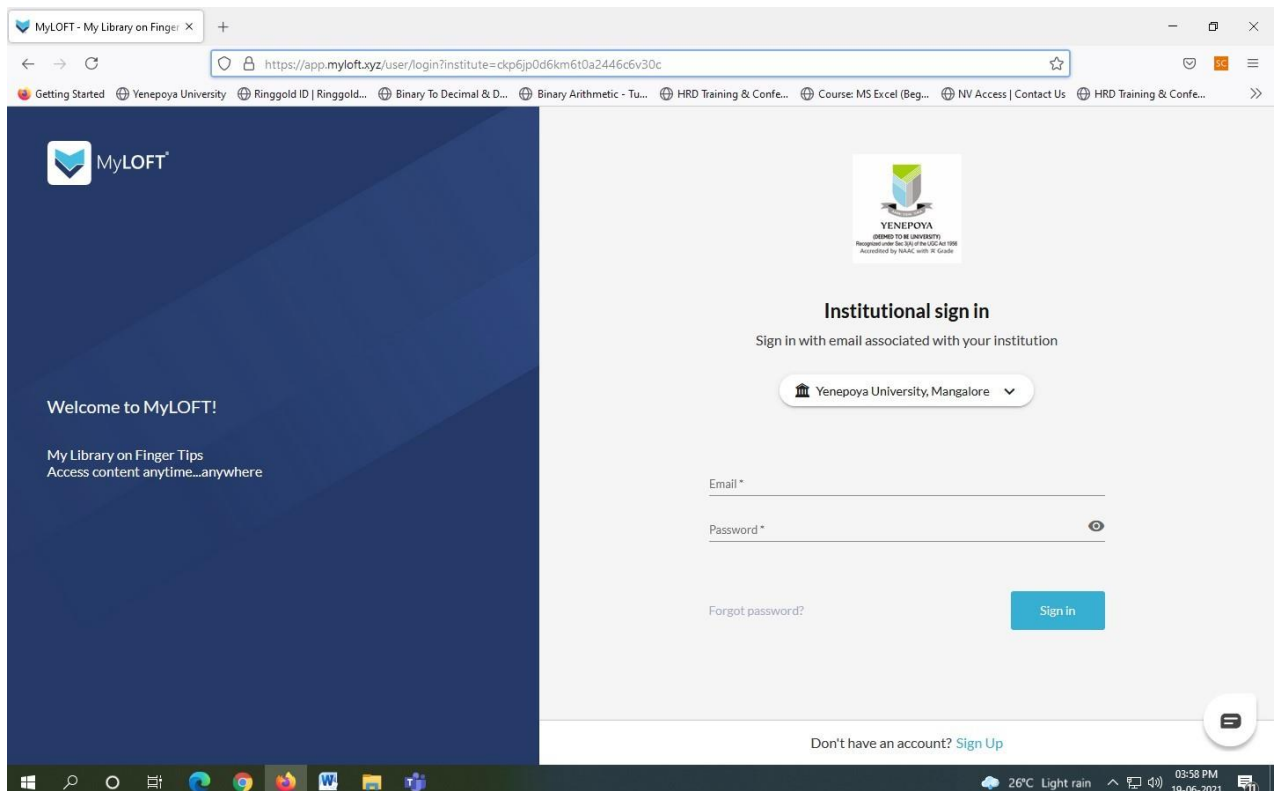

Login Successful Page on Web

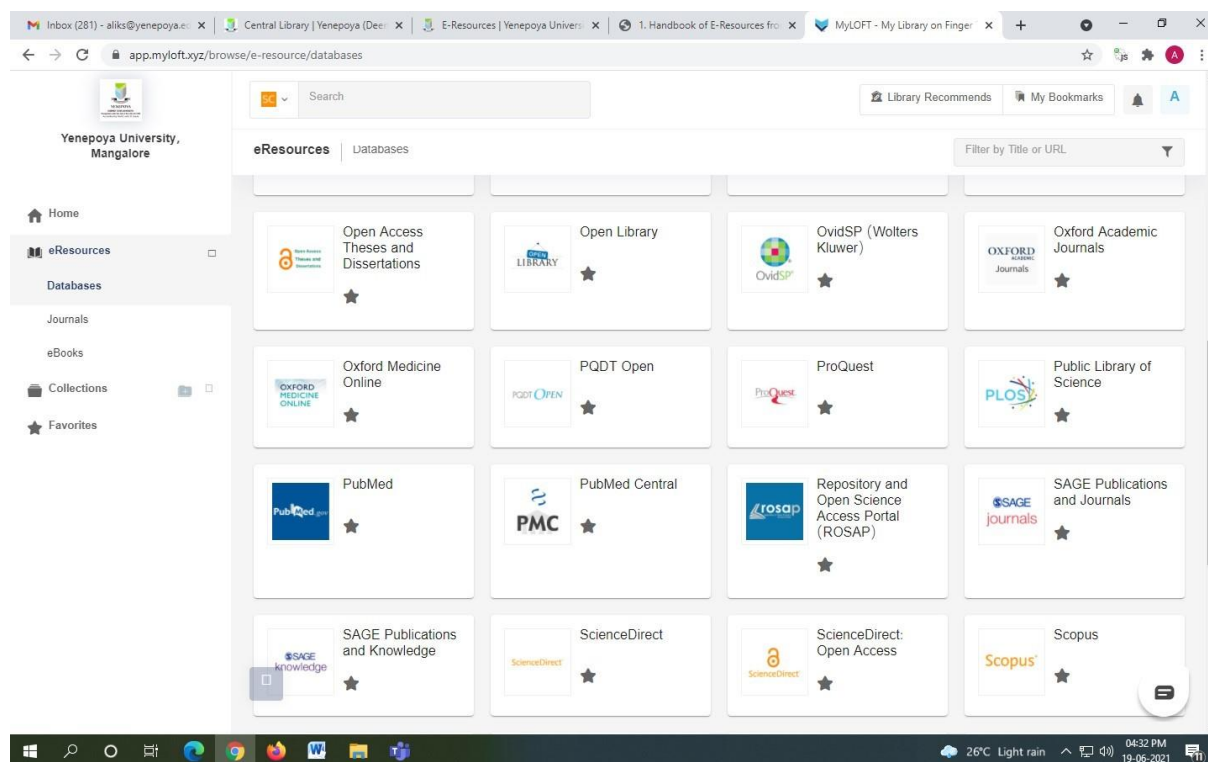

More Details kindly download

1. [MyLOFT Brochure](#)
2. [MyLOFT – Yenepoya Circular](#)

If any technical issues / access problem / training required kindly contact – **Dr. K. S. Ali**,
Dy. Librarian & Assitant Professor, Central Library, Yenepoya (Deemed to be University),
Email ID – aliks@yenepoya.edu.in, Extn. No. 5085, ph. 9686618671
